

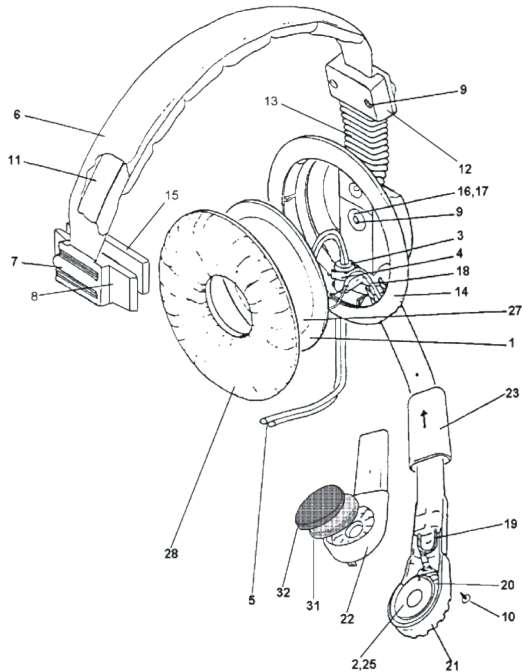

ATTENZIONE! CON ALCUNE CUFFIE PARTICOLARMENTE EFFICIENTI È POSSIBILE SUPERARE I LIMITI MASSIMI DI PRESSIONE ACUSTICA AMMESSI DALLE NORMATIVE VIGENTI, CON CONSEGUENTE RISCHIO DI DANNI PERMANENTI ALL'UDITO. E' RESPONSABILITÀ DELL'UTILIZZATORE VERIFICARE CHE QUESTO NON SI VERIFICH.

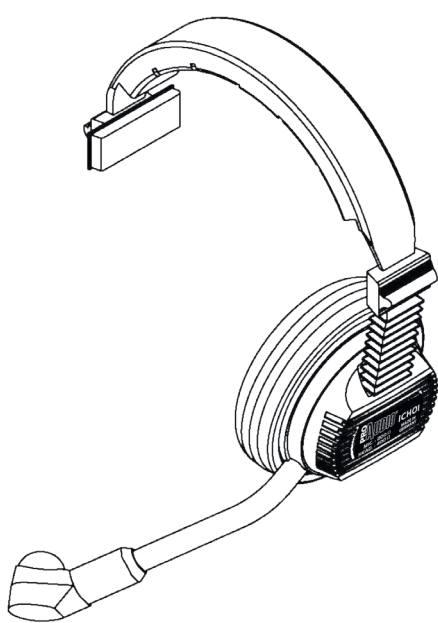



L'ICHO1 è fornito di fabbrica con un conduttore XLR femmina a 4 poli cablato come segue:

Cablaggio	
Pin1 : massa microfono	schermo + blu
Pin2: segnale microfono	rosso
Pin3: massa cuffie	marrone
Pin4: segnale cuffie	giallo + grigio

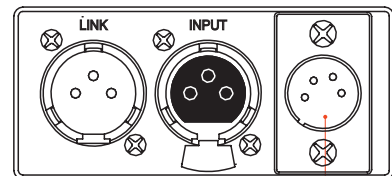
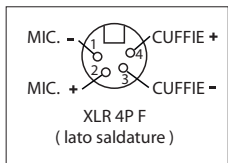

Esempio di collegamento alla stazione IC200B della serie INTERCOM 200.



Caratteristiche tecniche

Cuffie	
Tipo	mono-padiglione dinamiche
Risposta in frequenza	40 Hz -14 KHz
Impedenza nominale	400 Ω
Sensibilità	94 dB s.p.l. ad 1 mW
Potenza massima	500 mW
Pressione media esercitata sull'orecchio	-6N
Microfono	
Tipo	dinamico unidirezionale
Risposta in frequenza	40 -15.000 Hz
Impedenza nominale	200 Ω a 1KHz
Sensibilità	3 mV/Pa
Rapporto avanti/indietro	15 dB (DIN/IEC)
Connessione	
Conduttore	XLR 4 poli femmina compatibile con sistemi di terze parti
Cavo	1.50 mt
Peso	
Peso (cavo di connessione escluso)	210 g



CAUTION! WITH SOME HIGH EFFICIENCY HEADPHONES THE MAXIMUM SPL LEVEL ALLOWED BY CURRENT SAFETY REGULATIONS MAY BE REACHED, RESULTING IN THE RISK OF PERMANENT HEARING DAMAGE. IT IS THE USER'S RESPONSIBILITY TO AVOID THIS RISK, WITH A CAREFUL ADJUSTMENT OF THE HEADPHONES VOLUME CONTROL.



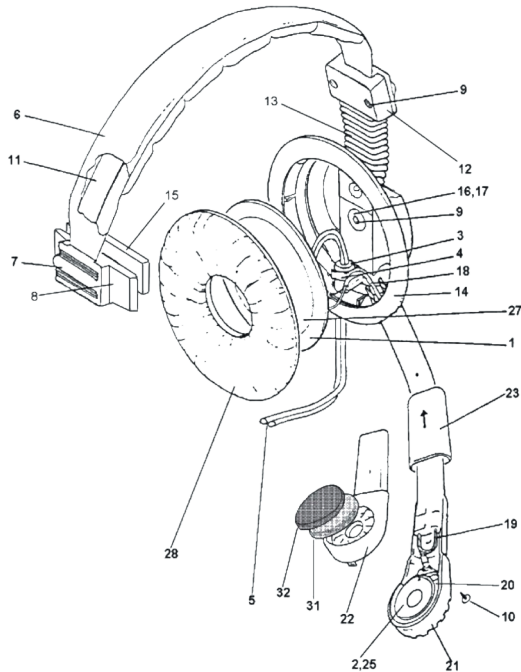
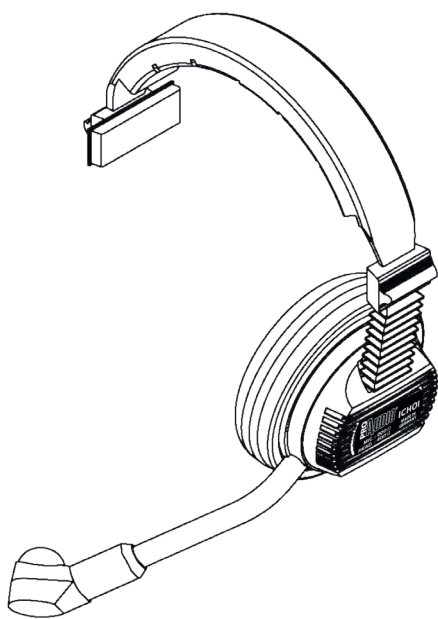

The ICH01 is factory fitted with a 4 pole female XLR connector wired as follows:

Wiring	
Pin1: microphone ground	screen + blu
Pin2: microphone signal	red
Pin3: headphones ground	brown
Pin4: headphones signal	yellow + grey

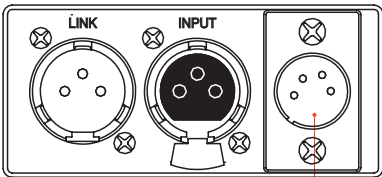
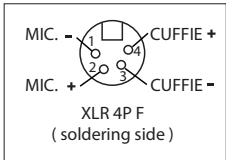

Sample of connection to INTERCOM 200 series IC200B station.



Technical specifications

Headphones	
Type	dynamics - single ear
Frequency response	40 Hz -14 KHz
Nominal impedance	400 Ω
Sensitivity	94 dB s.p.l. at 1 mW
Maximum power handling	500 mW
Average pressure on the ear	-6N
Microphone	
Type	dynamic - unidirectional
Frequency response	40 -15.000 Hz
Nominal impedance	200 Ω
Sensitivity	3 mV/Pa
Front-to-back ratio	15 dB (DIN/IEC)
Connection	
Connector	female XLR 4 poles, compatible with third parties systems
Cable	1.50 mt
Weight	
Weight (without connection cable)	210 g