

C6015

Light-weight swivel double aluminium clamp for truss, 100kg load, 48-51 mm tubes

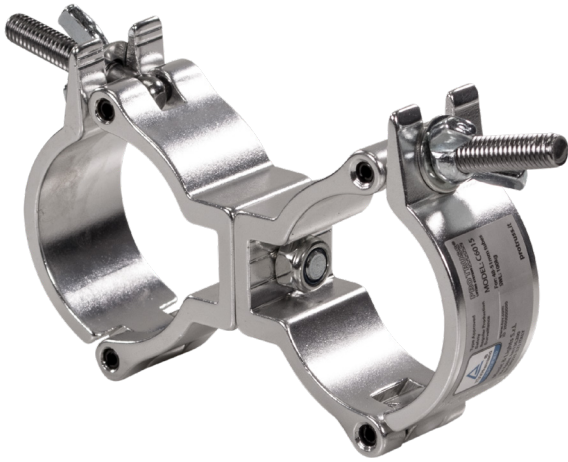

Light-weight swivel double aluminium clamp for truss, slim design.

MAIN FEATURES

- SWL (Safe working load): 100 kg
- Fits 48-51 mm diameter tubes
- High tensile aluminium

VERSIONS

Code	Housing
C6015A	Silver
C6015B	Black