



GUIDELINES FOR REPLACING THE ANIMATION WHEEL



Mosaico XL

540W IP66 zoomable LED image projector
with CMY and framing shutter

1

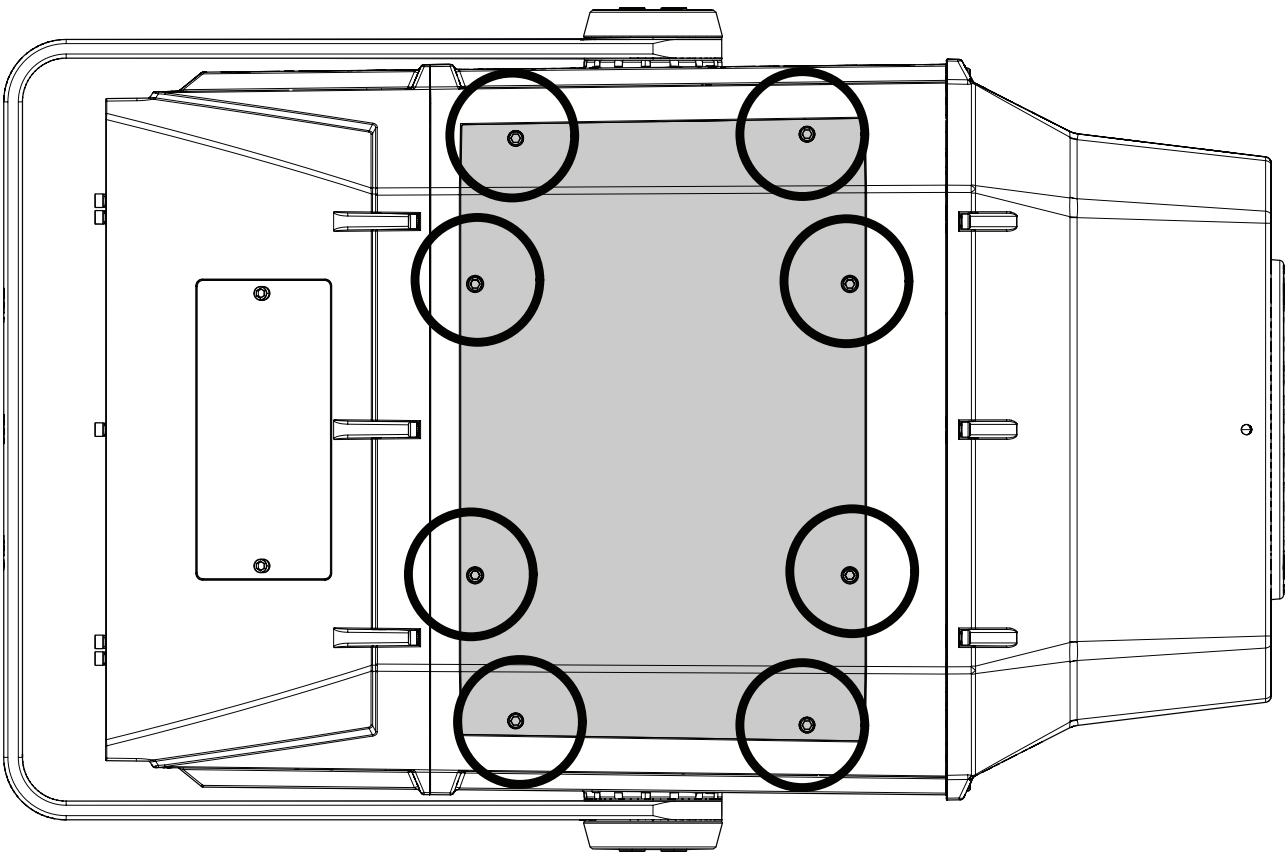

Use a 4 mm allen key (hex wrench) to remove the marked eight screws of the top cover.

2

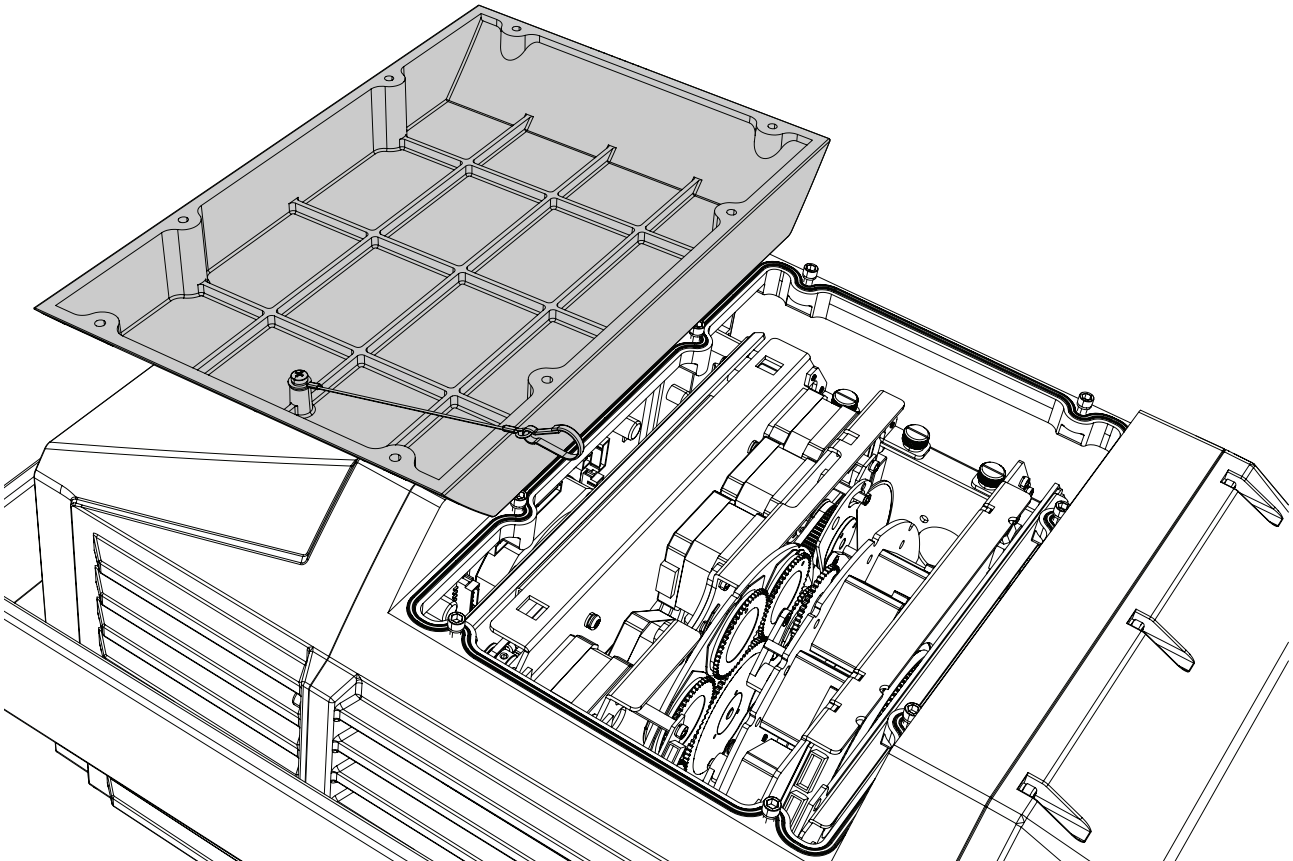

Lift the top cover off the fixture. For ease of access, and if it is safe to do so, you can unclip the safety cable and remove the cover completely from the fixture.

3

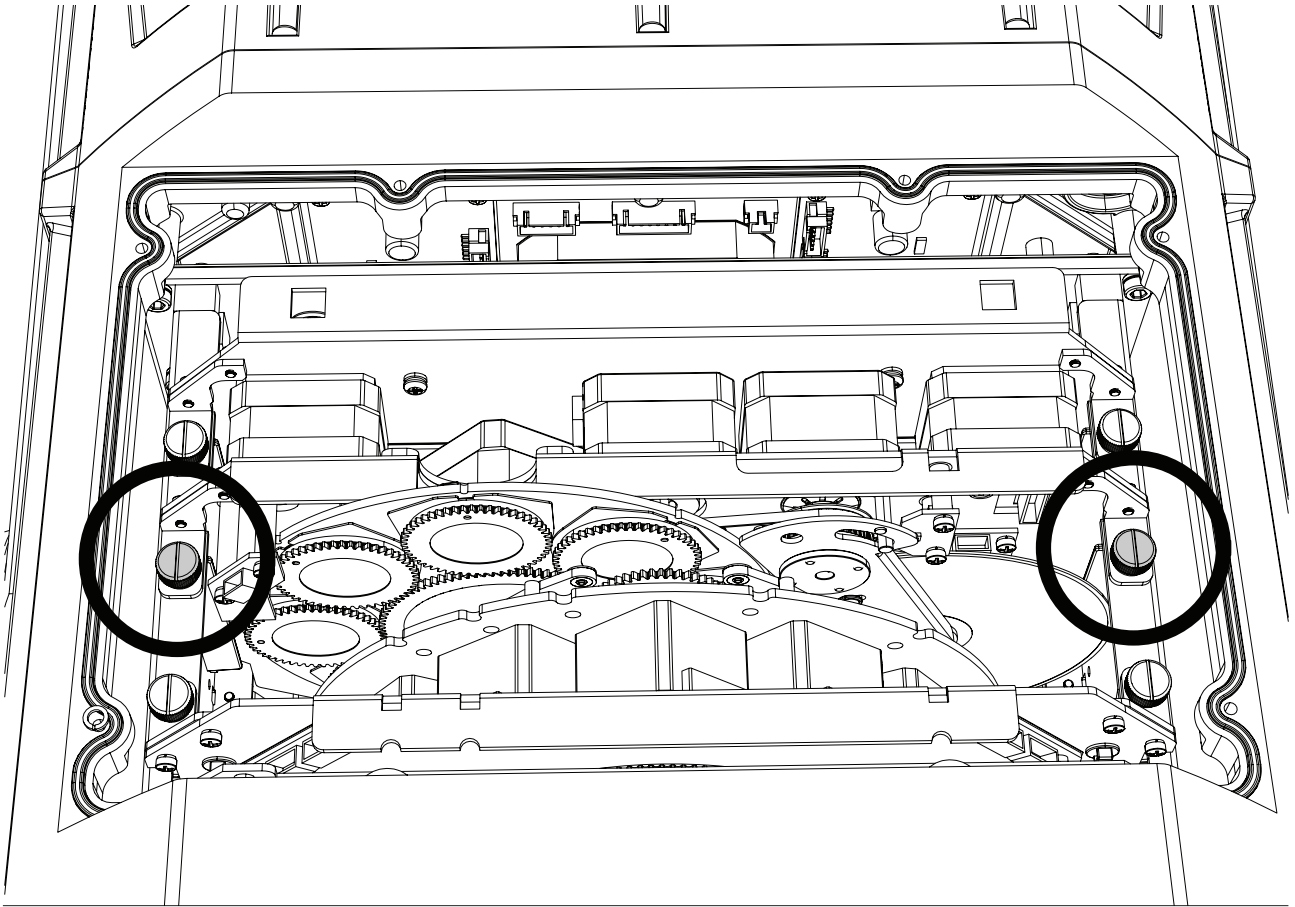

4

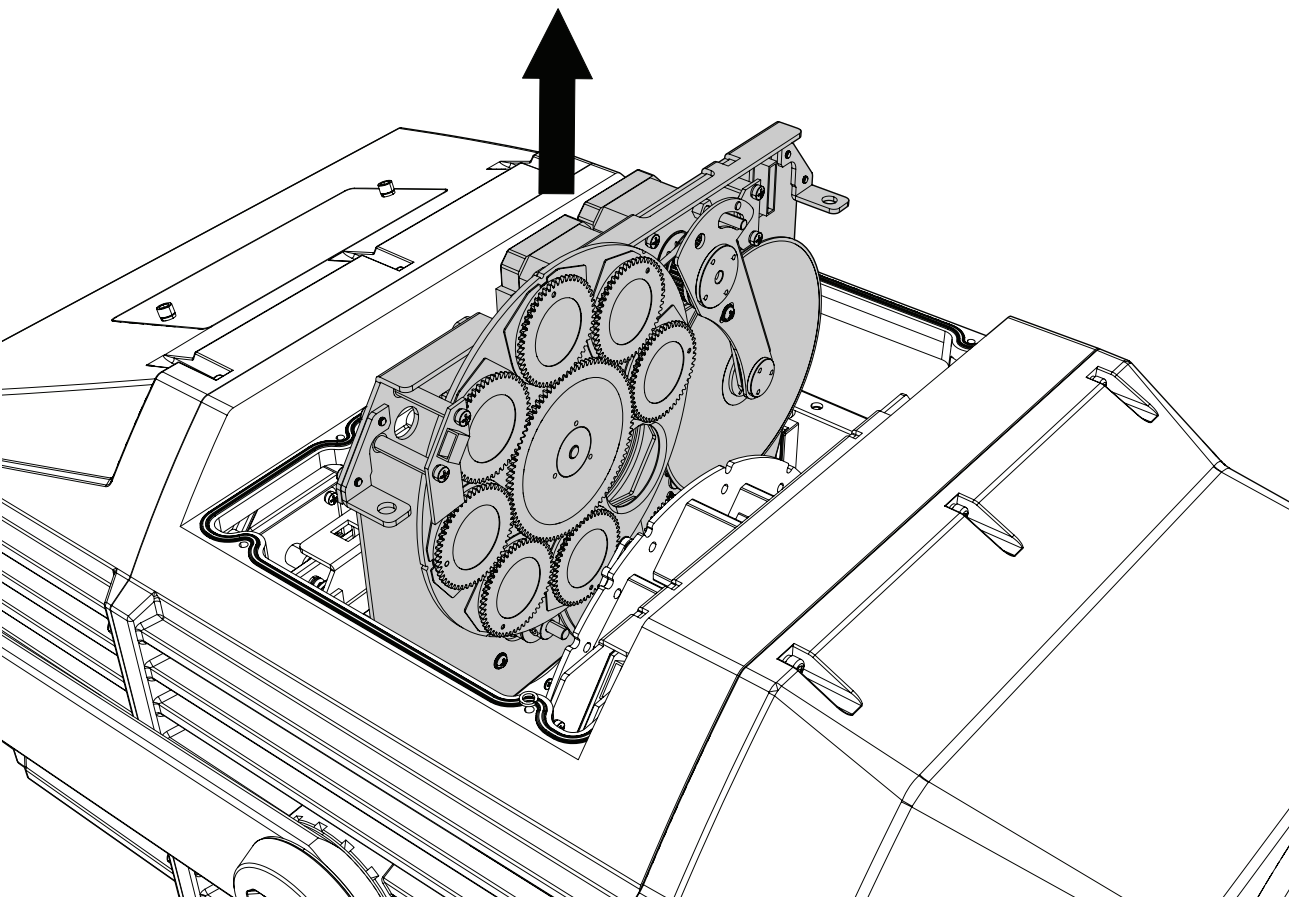

Use a flat screwdriver to remove the marked two screws (3). Then gently remove the module (4).

5

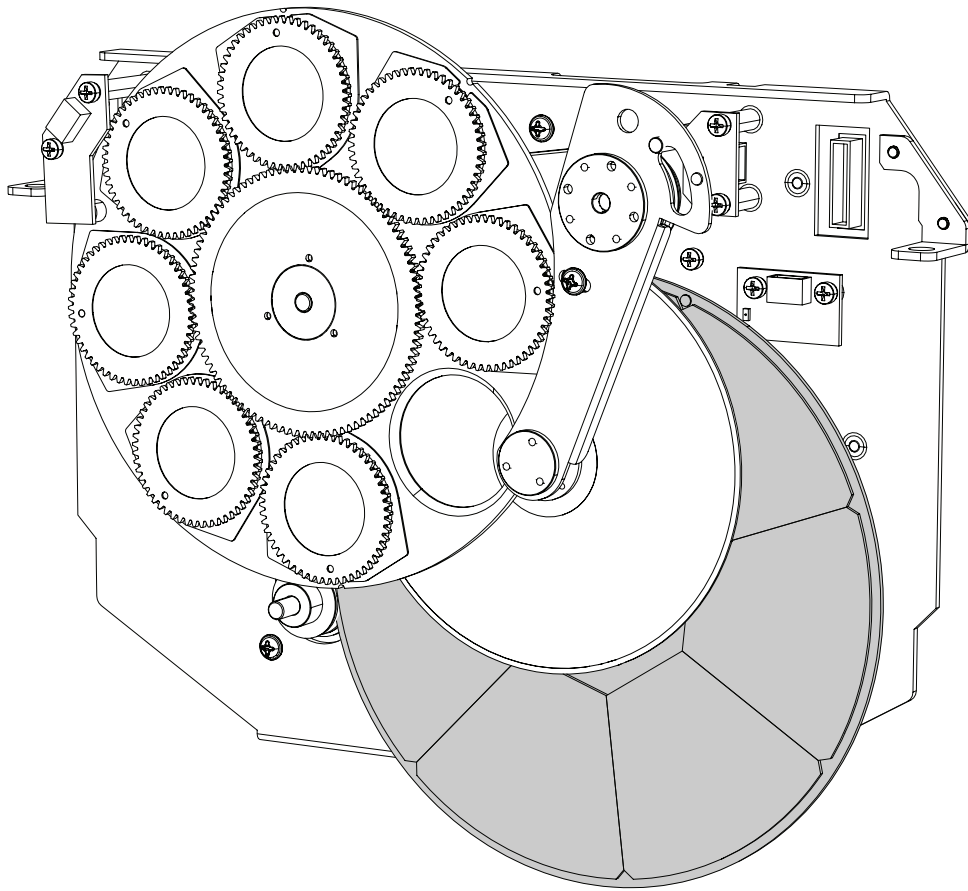

6

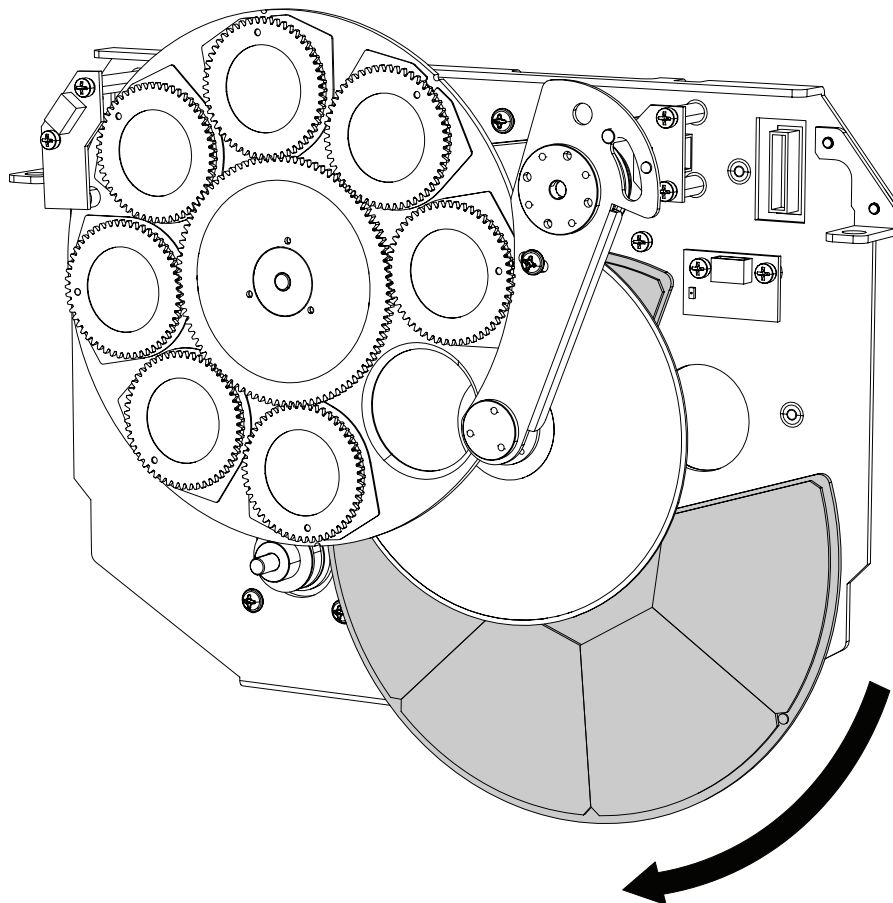

Move the marked color wheel so that the open coincides with the hole of the module (8). _ _

7

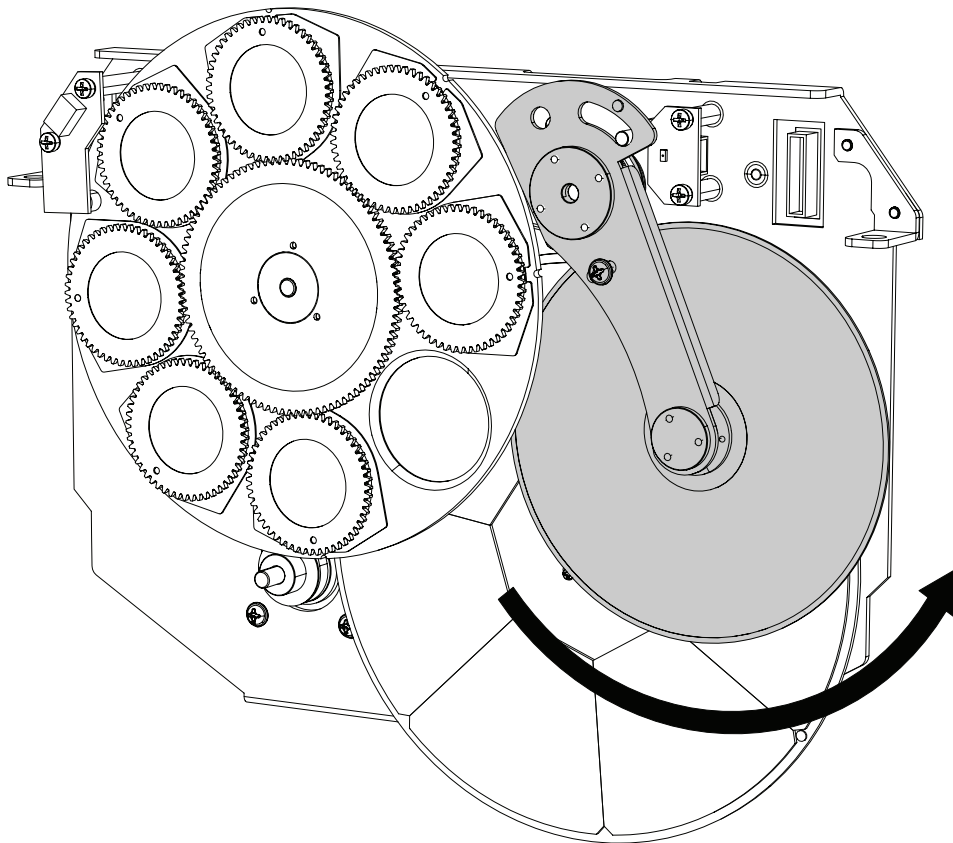

Move the marked animation wheel so that the center coincides with the hole of the module (8).

8

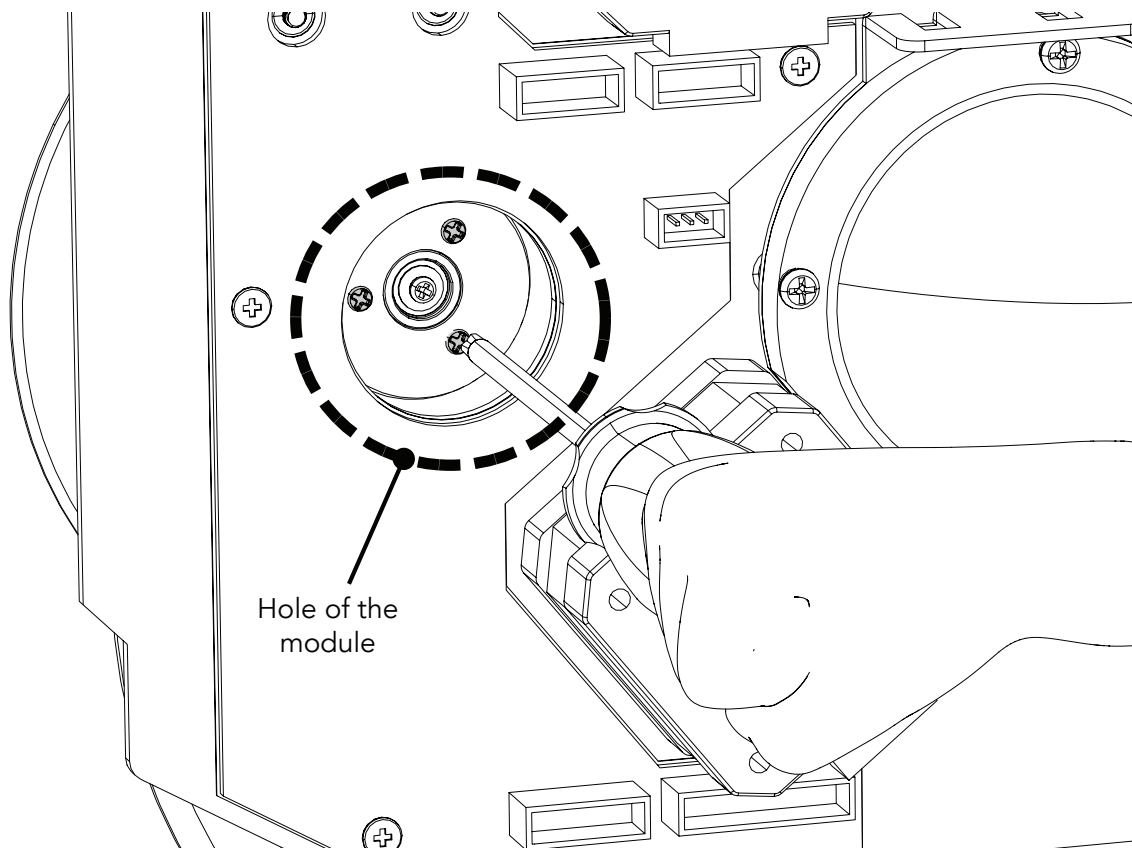

Use a flat screwdriver to remove the marked three screws (8). Then gently remove the module and replace it with a new one. Insert the module inside the product following the reverse procedure.
